

Glassforce 155 Surface Mount Balustrade Channel

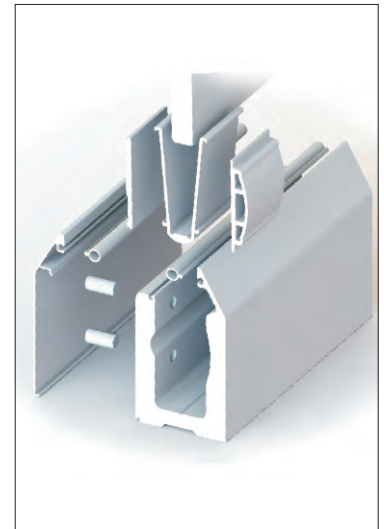

Product Features

- A unique slim design that is easy to install and easy to adjust.
- Installation can be achieved from the deck side which makes it ideal for situations where scaffolding may have been required in the past.
- Suitable for a range of glass thickness from 12mm to 17.5mm Toughened or Toughened/Laminated glass options.
- Ideal for internal or external Balustrading and Pool Fencing.
- Can be fixed to timber, concrete or steel with appropriate fixings.
- Pre-drilled channel for ease of installation, with no holes required in the glass for added safety and strength.
- Available in Mill or Silver Pearl finish. Custom powdercoat colours available.



Glassforce 155 Surface Mount Balustrade Channel

Product Code	Description	Finish
SM1M	Base Channel	M
SM2M	Covers, Mill Finish	M
SM2SP	Covers, Silver Pearl	SP
SMT	Timber Fixing Kit	
SMC	Concrete Fixing Kit	
SM5M	End Cap, Mill Finish	M
SM5SP	End Cap, Silver Pearl	SP

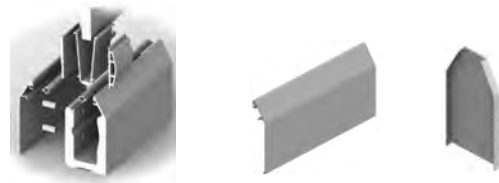

Base Channel

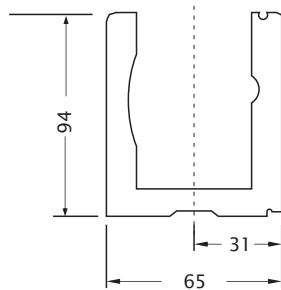

Cover



Balustrading Fixing Options

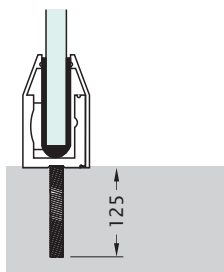

M10 at 200 ctc
chemset

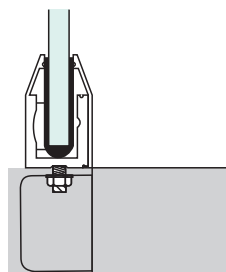

M10 at 400 ctc
Bolt

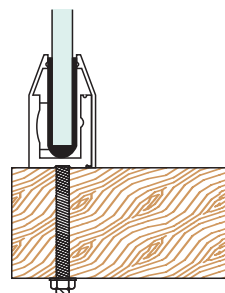

M10 at 200 ctc
Bolt

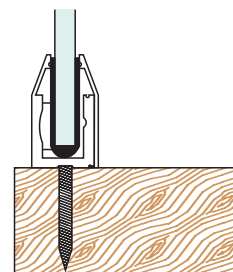

Internal M10x95mm at 200ctc
Eternal M10x112mm at 200ctc

Pool Fencing Fixing Options

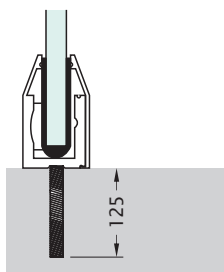

M10 at 200 ctc
chemset

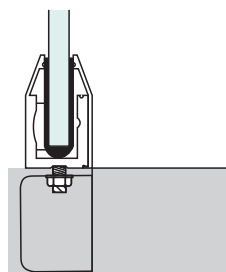

M10 at 400 ctc
Bolt

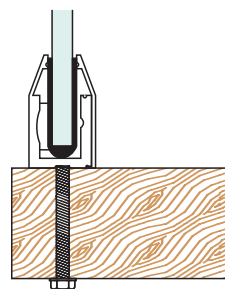

M10 at 200 ctc
Bolt

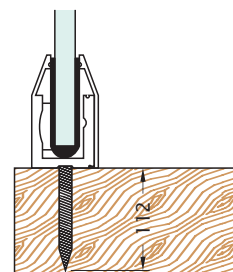

M10 at 200 ctc
Coach Screw

